

# MERCiO

INSTALLATION  
MANUAL

## **Thank you for purchasing our product.**

Please read these instructions carefully and refer to them during installation to ensure that your product is installed safely and maintains its high-quality finish.

### **Electrical Safety Information**

Please read the instructions and warnings carefully before installing the product and ensure this document is kept with the product for future reference to ensure product longevity and in the interest of safety.

- Any modification will invalidate the warranty and may render the product unsafe.
- This product is IP44 rated and suitable for installation in Zones 2 and outside the zone according to the IEC regulations.
- It is not suitable for use in saunas, steam rooms and shower cubicles.
- Appropriate circuit protection should be available for the products.
- Take suitable precautions when handling products.
- Do not install or use the product if it is broken or unsafe.
- This product is designed for installation into a drywall, if mounting onto other substrate, ensure appropriate fixing and battens (if required) are used and the load bearing of the wall is sufficient.
- Always switch off the electrical supply to the product at the mains during installation and maintenance.
- It is recommended that two people install this product.



### **Handling Tips**

We suggest not placing the product on a hard surface and always lifting it with two people or more.

- Different hanging systems are provided depending on the design of the products. Refer to diagram below and hanging system provided along with the product.
- Measure and install the hanging system on the wall using the appropriate wall fixings for your wall type.

## Tools Required



Drill



Spirit Level



Screwdriver

## How to Install LED Mirror in Your Bathroom

1

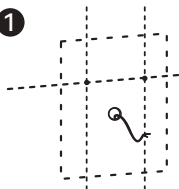

Pencil



Tape measure



Spirit level

2

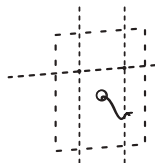

①

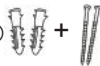

②



Drilling machine



Flat Screwdriver

Place the mirror on the wall to **mark the points** for hook installation.

**Drill on the marked points** and fix the hooks using dowels and screws. ①/②

3

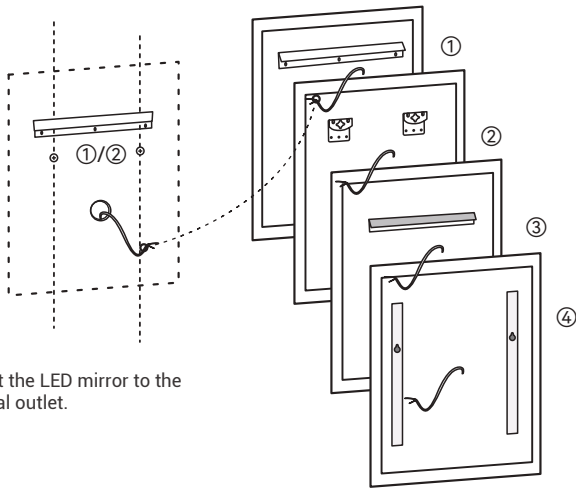

Connect the LED mirror to the electrical outlet.

4

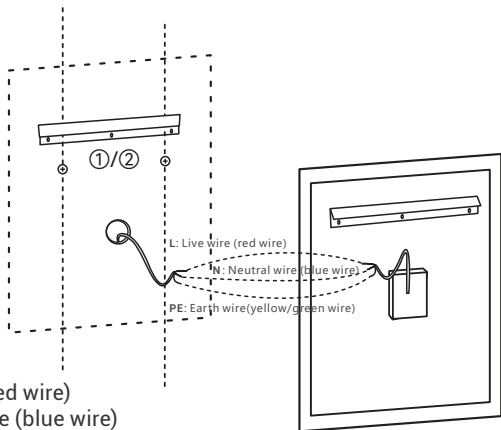

**L:** Live wire (red wire)  
**N:** Neutral wire (blue wire)  
**PE:** Earth wire (yellow/green wire)

5

**Install the mirror carefully** on the wall and make sure it is fixed firmly.

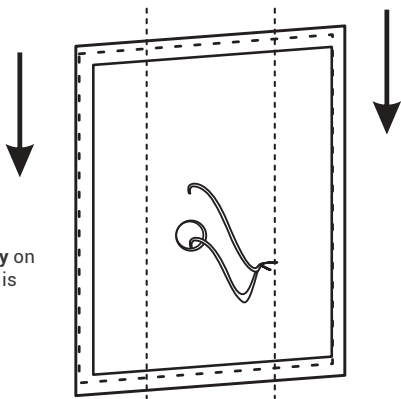

6

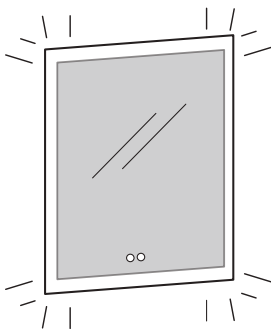
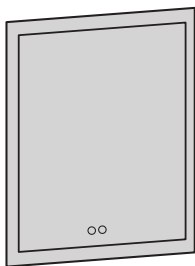

**Switch on the electric supply** to test your LED mirror.

## User Manual

Note : After connecting the power, all the switch buttons will light up in blue. When using different functions, the corresponding button will change from blue to white.

### LED LIGHTING



Touch this sensor once to switch the LED lighting on or off.

### Buttons display



Switch button and Defogging button

### How to turn on/off the mirror

Press the Switch button to turn the LED mirror on/off. Allow a 5-second interval between presses.

### How to change the lighting colour

Change lighting colour: Quickly press the Switch button to change the lighting colour. Ensure that the interval between clicks is less than 5 seconds.

### Defog

Press the Defog button to switch it on/off.

The defogging function will automatically turn off after one hour of operation.

### How to turn on/off integrated motion sensor

Hold the defog button for 3 seconds to switch sensor function on/off

### How the integrated motion sensor works

Once the function is turned on, when the user approaches within a range of 1.5 to 2 meters, the lights will automatically illuminate, providing optimal visibility. Once the user moves away from the mirror, the lighting will automatically turn off after 60 seconds, enhancing energy efficiency and convenience.

## ADJUSTABLE LIGHT COLOUR ( WHERE APPLICABLE )



1. If the light is not lit, please touch it once first.
2. Long press the button to adjust the color temperature.

## DEMISTER ( WHERE APPLICABLE )



1. Touch this sensor to switch on the demister.
2. Normally, the demist function will turn off automatically after one hour of inactivity.

## Cleaning and Maintenance

- Please clean mirror surface with a mixture of 30% isopropyl alcohol and 70% water and use a soft micro-fibre cloth/chamois.
- Ensure the mirror edges are completely dry after cleaning..
- Wipe up all water spills immediately.

### Concrete and Aluminium Frames:

- Please use a soft micro-fibre cloth/chamois and warm water
- Do not use any abrasives, acidic, or alkaline-based solvents/cleaners. Avoid sharp objects and keep heat and hot objects away from all surfaces of our products.
- Ensure the mirror and its surroundings remain dry to prevent long-term water damage or corrosion.